

solo x

wireless rechargeable keyboard



FEATURES

- Ultra-slim design to slip into a laptop bag
- Low travel, scissor-key structure for an excellent typing experience
- Rigid aluminium casing with attachable tilt-strip
- Full-sized keycaps with hi-definition markings
- Rechargeable wireless 2.4G technology

SOLO X	
Colours available:	black
Net weight and size:	330 g; 307 x 122 x 18 mm
Package weight and size:	420 g; 330 x 155 x 26 mm
Code:	ST352321
EAN:	0 601577 559665



How to set up your **solo X** keyboard

System requirements:

PC with Windows XP, Windows Vista, Win 7, Win 8, Win 10

How to set up the keyboard:

1. On the right side of the keyboard, switch the ON/OFF button to ON.
2. Insert the USB dongle provided into one of the PC's USB ports. The keyboard features plug-n-play software, so there is no additional action required.
3. If keyboard does not function correctly, then reset as described below.

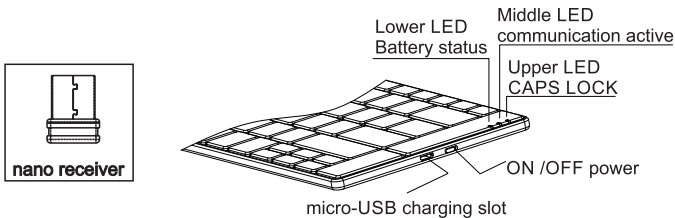

LED light functions:

There are 3 LEDs on the right upper corner of the keyboard:

1. Lower: Battery status. RED When battery is low. RED when charging via USB turning GREEN when fully charged.
2. Middle: Blue when USB dongle gets connected to the computer and communication between keyboard and computer is active.
3. Upper: Blue When Caps Lock is active

Multimedia Hotkeys functions

FN+ESC=Media Player
 FN+F1=Play/Pause
 FN+F2=Previous Track
 FN+F3=Next Track
 FN+F4=Volume Up
 FN+F5=Volume Down
 FN+F6= Mute (Windows)

FN+F7= Web home
 FN+F8= Search
 FN+F9= Favorite
 FN+F10= Email
 FN+F11=Screen Lock
 FN+F12= My computer

How to recharge:

On the right side of the keyboard there is a micro-USB slot. To recharge from the PC directly use only the cable provided or alternatively use a standard phone charger with no power charging function.

How to Reset:

In case the keyboard encounters error in communication with the computer, follow the steps below to reset to the factory settings:

1. Check if the battery level is too low. If lower LED is RED, then recharge is required.
2. Press "Esc" and "K" keys at the same time, and after 2 seconds insert the USB dongle in the PC's USB port, keeping the key pressed.

Riser strip:

A magnetic riser strip is included with the keyboard and if required it will self- locate to the embedded magnets at the top of the keyboard base.

WARNING:

To recharge from the PC directly use only the cable provided or alternatively use a standard phone charger with no power charging function.

STANDIVARIUS

Pairing your replacement USB dongle with Solo X keyboard

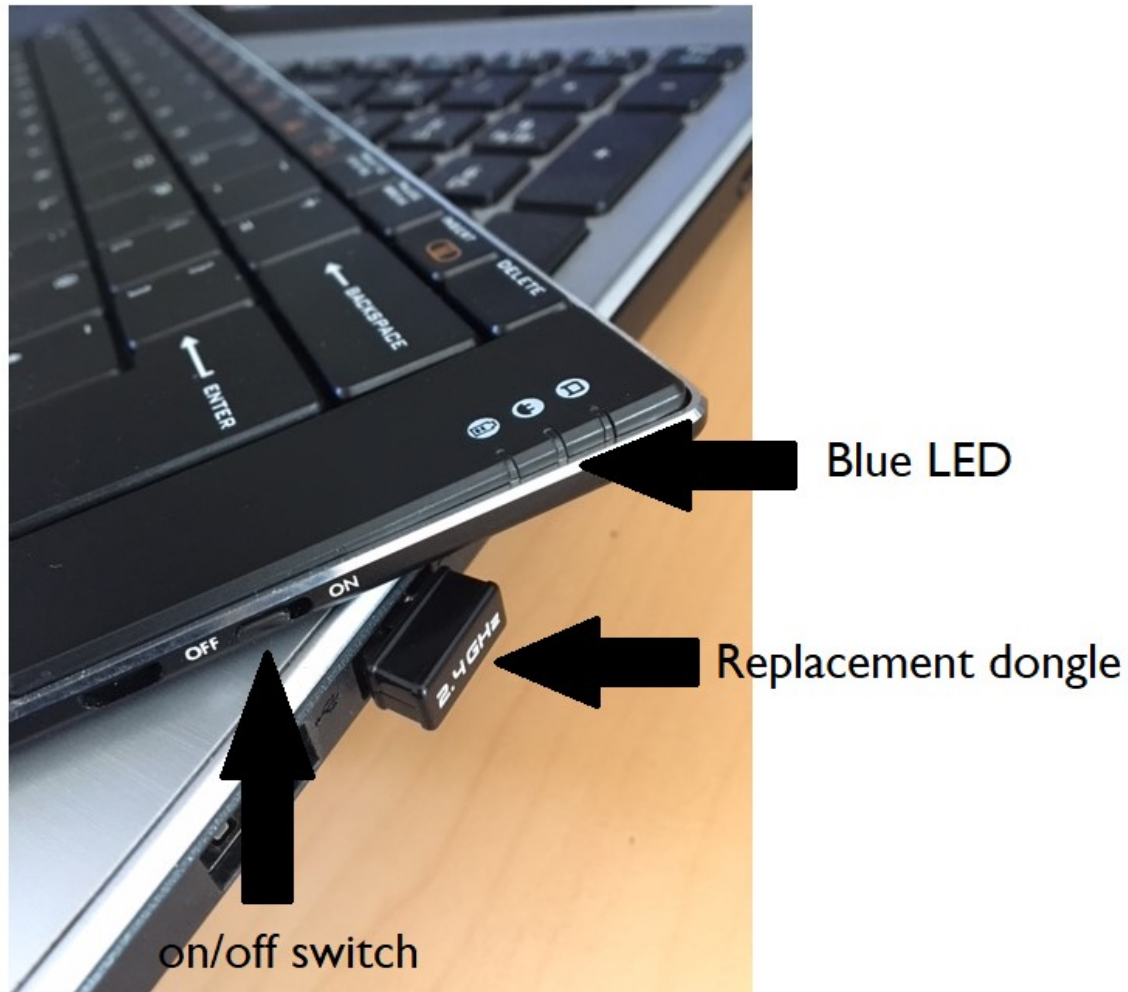

If the red LED is on, then recharge the keyboard.

Pairing instructions:

1. Switch off the keyboard using the switch on the right-hand edge.
2. Insert replacement dongle into a spare USB port on your laptop.
4. Place Solo X keyboard directly adjacent to the replacement dongle.
5. Switch on keyboard using the switch on the right-hand edge. As the blue LED flashes press the **Esc** and **K** keys simultaneously and release.